

**USER NOTICE
FOR AQUARION MODELS
AQ100 and AQ100H130**

Purpose of Notice

This notice is to provide instruction on how to perform service, inspection and maintenance of the AQ100 and AQ100H130 models without piercing fluid cartridges.

INSPECTION OF UNIT INTERIOR

- A. To inspect the interior of unit, remove Lid Assembly (**Figure 1**).

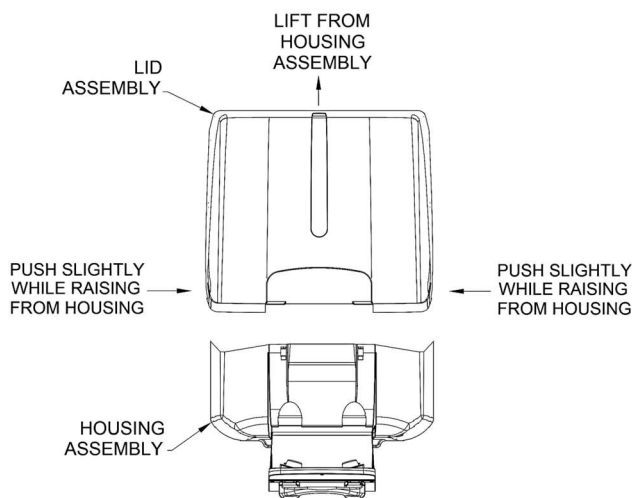

FIGURE 1

INSPECTION OF TRAY ASSEMBLY

- B. To inspect Tray Assembly utilizing Override Latch. Override Latches are located on underside of handle (**Ref Figure 2**). Both latches must be fully depressed to allow tray to open.
Note: The only way to open Tray Assembly without breaking easy Break Security Tag and activating Fluid cartridge is to use the override latch.

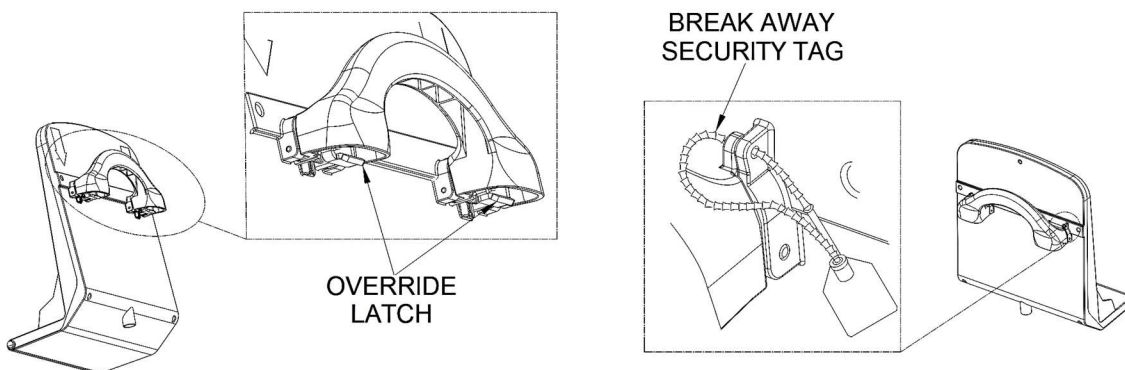

FIGURE 2

USER NOTICE
FOR AQUARION MODELS
AQ100 and AQ100H130

INSPECTION OF TRAY ASSEMBLY

- C. With the tray open, press the tabs on the snap locks forward towards the front of the tray and carefully remove nozzle assembly (**Figure 3**).

NOTE: Caution should be exercised when removing nozzle assembly for risk of penetrating the seal on fluid cartridge.

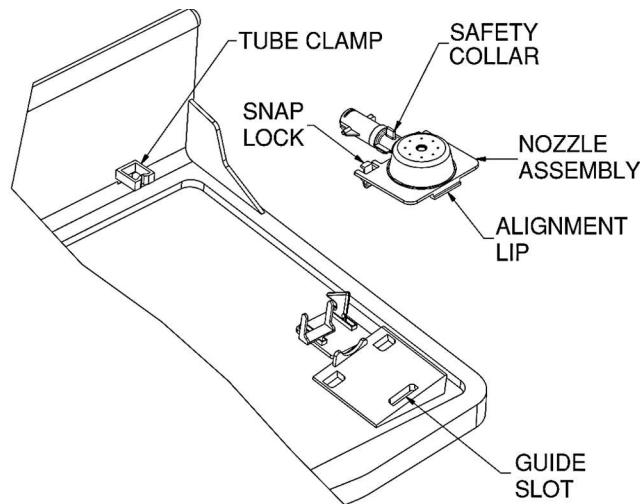

FIGURE 3

- D. With the tray open and nozzles removed, Function test tray handle lock/latch by pressing and releasing the override lock/latch (Ref. Step B). Pressing/releasing override lock/latch will move tray handle locks back and forth in their slots.
Note: tray handle lock/latches should move back and forth smoothly in their slots. (**Figure 4**).
- E. Function test Tray assembly by lifting tray up and down without fully closing the tray. Tray assembly should move freely up and down smoothly without any restriction.

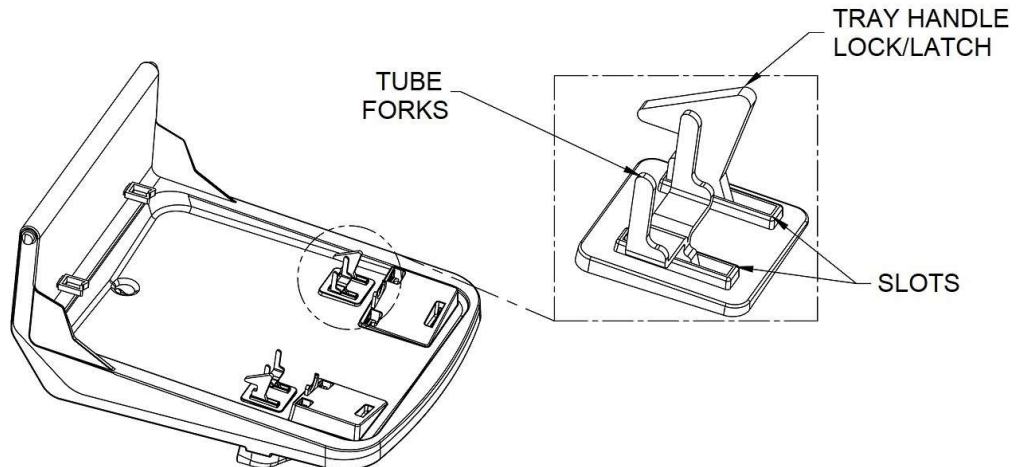

FIGURE 4